

DOWNTOWN TREE PLANTERS

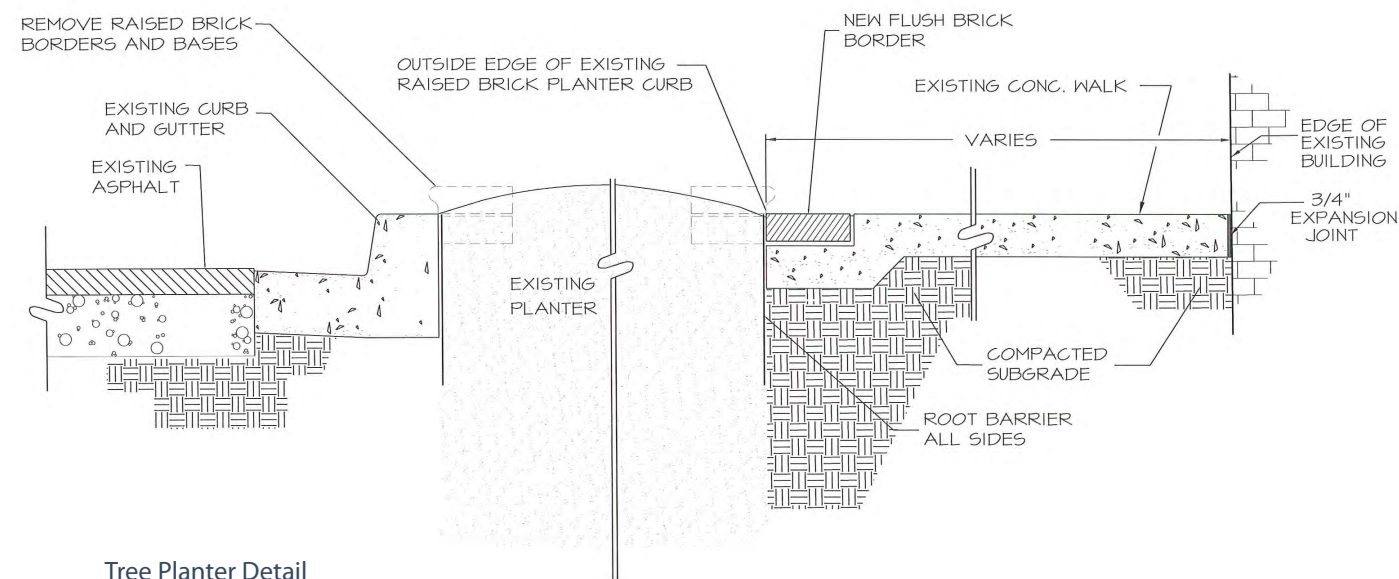

Tree Planter Detail

The existing live oak trees in the downtown streetscapes have matured to the extent that the root system has begun to buckle up portions of the existing raised brick planter curbings. With the understanding that this scenario is likely to continue at all planter areas, a modified planter design is recommended for all planters. Widening the planter areas parallel to the street curb and relative to the existing concrete score joints, and installing root barriers along with a new flush brick planter border will assist in alleviating some of the issues of the raised planter curbings. After consultation with a licensed arborist, some of the existing live oaks may need to be replaced, at which time an alternative tree species may be considered.

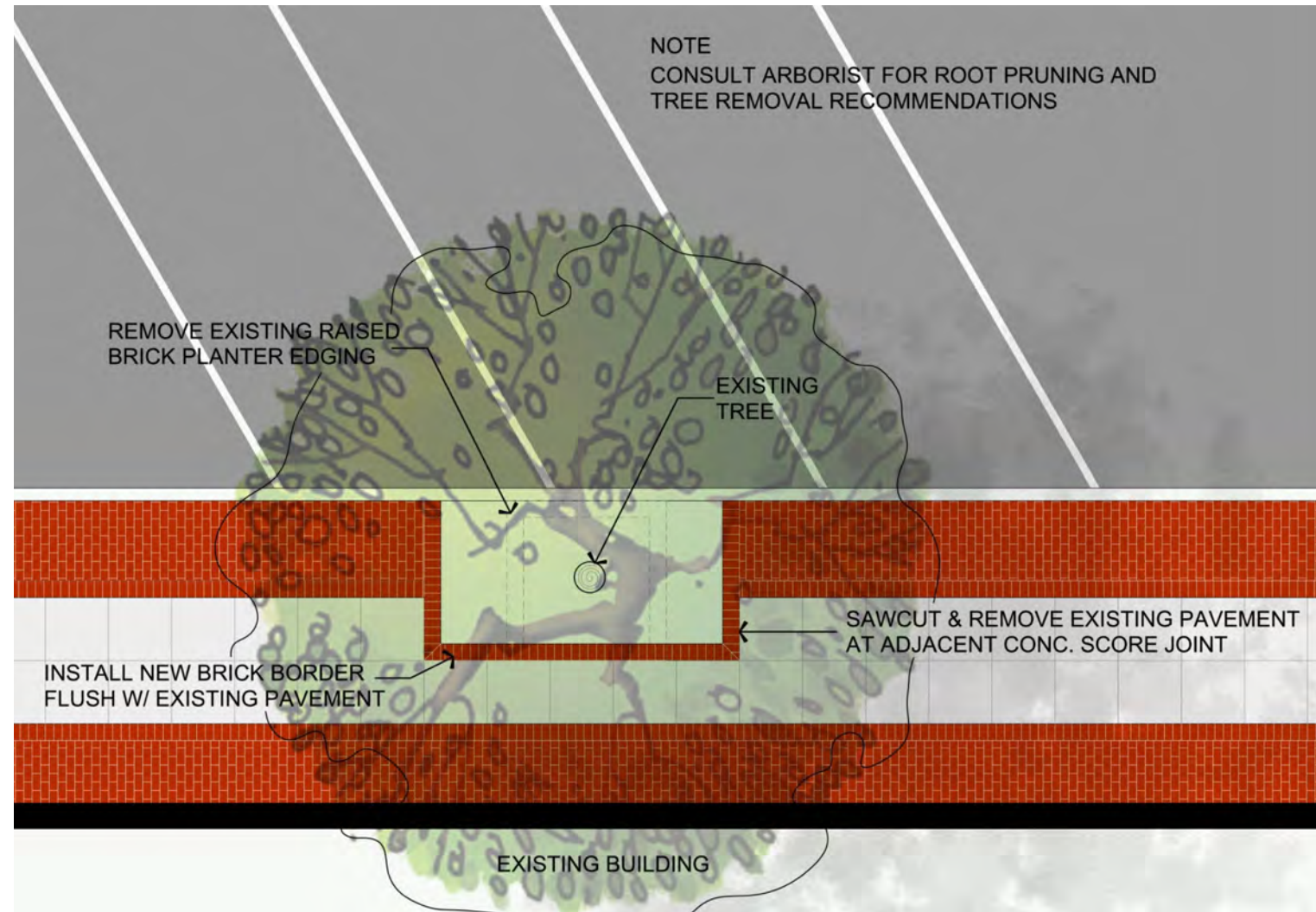

Existing Downtown